

Park Lane, Leigh, WN7 2LA
Offers Over £180,000

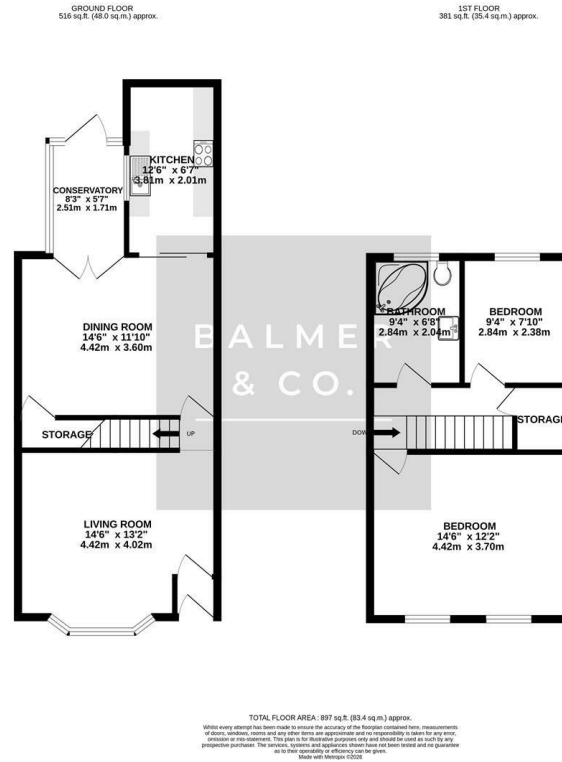

BALMER & CO in LEIGH are delighted to offer FOR SALE this fantastic two bedroom mid terraced property, located on Park Lane in Leigh. Offering spacious and immaculately presented living accommodation, which is not overlooked to the front, it is perfect for those looking to move in and unpack. The ground floor comprising in brief; entry opening into a bay fronted living room, second reception room with feature brick chimney breast, modern fitted kitchen and an additional conservatory. To the first floor is a large master bedroom, a single bedroom and a three piece bathroom suite. A storage cupboard on the landing, where you'll find the boiler as well as access to the loft, completes the internal accommodation. Externally, the property has a good sized garden frontage which is not overlooked, whilst to the rear there is a low maintenance, enclosed rear yard. Early viewings highly recommended, all enquiries welcome.

Floor Plan



Area Map

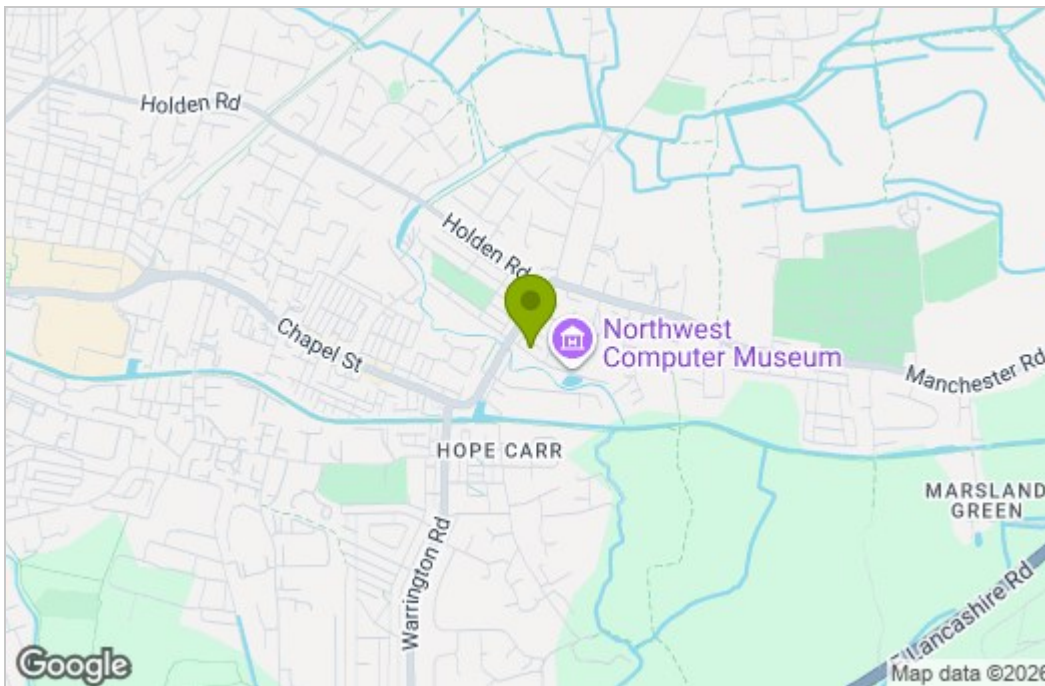

Energy Efficiency Graph

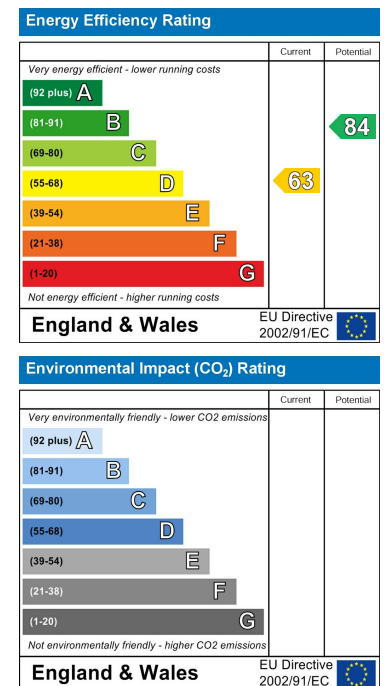

These particulars, whilst believed to be accurate are set out as a general outline only for guidance and do not constitute any part of an offer or contract. Intending purchasers should not rely on them as statements of representation of fact, but must satisfy themselves by inspection or otherwise as to their accuracy. No person in this firm's employment has the authority to make or give any representation or warranty in respect of the property.